

# *Taifun*<sup>®</sup>

GTC-R



User Manual

## Instructions for Use

Please read these instructions for use carefully before using the product and keep them for future reference.

### 1. Instructions for Use and Storage

Do not expose the product to humid environments or extreme temperatures, as this may cause damage. If water accidentally enters the device, stop using it immediately to prevent a short circuit. Do not use our product more frequently or for a longer duration than conventional cigarettes. Keep the product out of reach of children, adolescents, and pets.

### 2. Contraindications

When using liquids (with or without nicotine): Please follow the warnings and instructions provided with the liquid products, and never mix them with other substances. Do not use the product if you have a known sensitivity to nicotine or any other ingredients in the liquids. If you experience nausea, dizziness, or skin irritation, discontinue use immediately and consult a doctor. The electronic cigarette is not intended for smoking cessation.

### 3. Warnings

The sale to and use by children and adolescents under the age of 18 is prohibited. This product is not recommended for non-smokers. It is not suitable for pregnant or breastfeeding women, individuals with cardiovascular or respiratory conditions, alcohol dependency, or epilepsy. Do not use this product if you suffer from a lung disease (e.g., asthma, COPD, bronchitis, pneumonia). The vapor released may trigger asthma attacks, shortness of breath, or coughing fits in individuals with pre-existing lung conditions. If you experience any symptoms, consult a doctor immediately.

Do not use our product if you have a known issue (e.g., allergies, intolerances) with nicotine or any other ingredients in our product.

When using nicotine-containing liquids: Nicotine-containing products are not suitable for individuals who must avoid nicotine for medical reasons. If the liquid is swallowed, contact emergency services immediately. You may also contact your local poison control center (e.g., 24-hour hotline: +49 30 19240 in Germany).

### 4. Information on Possible Adverse Health Effects

None known; please refer to the instructions for use of the liquid.

### 5. Information on Addictive Potential

If you use products with nicotine-containing liquids, the following warning is provided on the packaging of the liquids: "This product contains nicotine: a highly addictive substance."

### 6. Toxicological Information

If the liquid is overheated in the electronic cigarette in a manner not in accordance with proper use, toxic substances may be produced. Therefore, please use the electronic cigarette strictly according to the respective manufacturer's recommendations/instructions for use. Use of this product is at your own risk.

### 7. Safety Instructions

Do not expose the atomizer to extreme temperatures; avoid prolonged direct sunlight and high humidity. Do not operate the atomizer in environments that may contain flammable gases, vapors, or dusts—risk of explosion!

Do not drop, throw, or apply excessive force to the atomizer to avoid damage; do not use the atomizer if you detect any damage. Refill the liquid in time to prevent dry hits. The atomizer becomes very hot during use; allow it to cool down before handling.

If you change flavors, replace the cotton as needed. Clean the atomizer regularly, as condensation and dirt may accumulate. Ensure that the battery mod used with the atomizer is suitable for the required power output; using battery mods without protective circuits is not recommended.

### Manufactured in Germany for:

SmokerStore GmbH	Phone: +49 (0)2336 / 935899-0
Talstraße 4	Email: <a href="mailto:info@smokerstore.de">info@smokerstore.de</a>
D-58332 Schwelm	Web: <a href="http://www.smokerstore.de">www.smokerstore.de</a>



## 1. PRODUCT DESCRIPTION

### Scope of Delivery

1x Taifun® GTC-R  
1x Drip Tip  
1x Aspire Nautilus Coil  
1x Spare Parts Bag  
1x Instructions for Use

### TECHNICAL SPECIFICATIONS

Dimensions:	53,0 x 23,0 mm	Weight:	~ 66,5 g
Thread:	510	Capacity:	~ 3,5 ml
Material:	Stainless Steel (1.4301) / PCTG / POM		

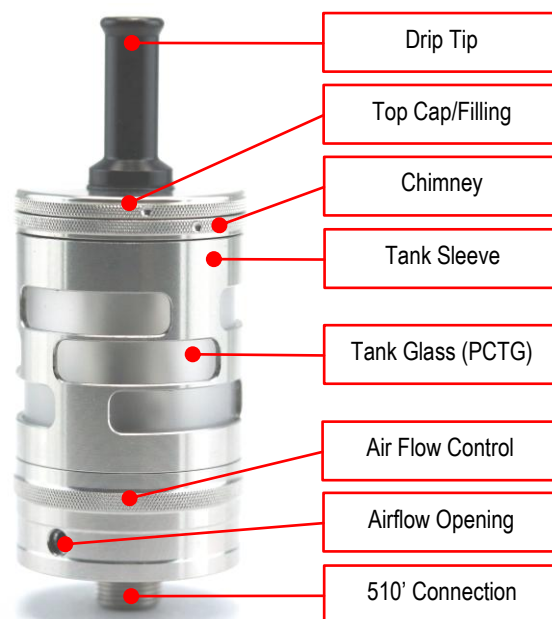

## 2. SAFETY INSTRUCTIONS

- Do not expose the atomizer to extreme temperatures; avoid prolonged direct sunlight and high humidity.
- Do not operate the atomizer in environments that may contain flammable gases, vapors, or dusts—risk of explosion!
- Do not drop, throw, or apply excessive force to the atomizer to avoid damage; do not use the atomizer if you notice any damage.
- Refill the liquid in time to prevent dry hits.
- The atomizer becomes very hot during use; allow it sufficient time to cool down.
- Replace the cotton if you change the flavor.
- Clean the atomizer regularly, as condensation and dirt can accumulate.
- Ensure that the battery mod used with the atomizer is suitable for the required power output; using battery mods without safety electronics is not recommended.

## 3. MANUFACTURER'S RECOMMENDATIONS

- Set your battery mod to an appropriate power level, depending on the installed coil head.

## 4. STORAGE INSTRUCTIONS

- If you do not use the atomizer for an extended period, empty the tank, remove the coil head, and clean the atomizer.
- Keep the atomizer out of reach of children and pets.
- Ensure that the atomizer is placed on a stable and secure surface.
- Store the atomizer in a clean and dry place; avoid high humidity.
- Do not store the atomizer at extreme temperatures; avoid prolonged direct sunlight.

## 5. DISPOSAL INSTRUCTIONS

- The packaging must be disposed of in an environmentally friendly manner.
- Products marked with the crossed-out wheeled bin symbol must not be disposed of with household waste. You can return these products free of charge to local retailers or municipal collection points. For more information, please contact your local municipal office, town hall, or waste disposal authority.

## 6. PRODUCT OVERVIEW

### COMPONENTS / PARTS LIST

<b>A</b>  1x base	<b>B</b>  1x AFC ring	<b>C</b>  1x tank insert	<b>D</b>  1x tank sleeve
<b>E</b>  1x chimney	<b>F</b>  1x top cap	<b>G</b>  1x drip tip	<b>H</b>  1x coil
<b>I</b>  1x ball detent	<b>J</b>  5x o-ring NBR 50 19x1 mm	<b>K</b>  1x o-ring NBR 50 15x1 mm	<b>L</b>  3x o-ring NBR 50 5x1 mm
<b>M</b>  1x positive pin insulator	<b>N</b>  1x positive pin	<b>O</b>  optional: full-tank	

#### IMPORTANT

The atomizer is delivered fully assembled. All O-rings and insulators are already correctly installed. This overview is provided for illustration purposes only and to assist with reassembly after cleaning the individual components.



## 7. START-UP

### INSTALLING THE COIL HEAD

#### IMPORTANT

Use only compatible coil heads. Specialist retailers offer various coil heads that can be used with the Taifun GTC-R and can assist you in selecting the appropriate one.

We recommend using Aspire Nautilus coil heads. These are available in different resistance levels.

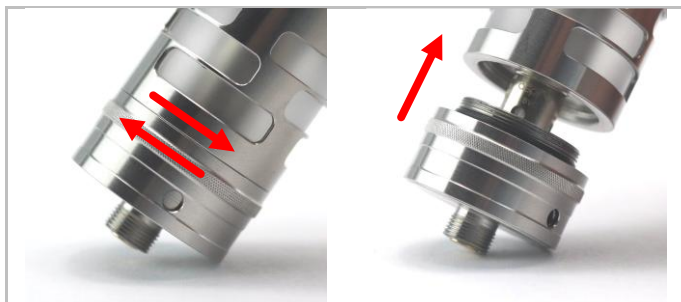

First, unscrew the tank from the base.



Place a suitable coil head onto the base and screw it in.



Optional: If a coil head is already installed in the base, it must be removed first.



Now the tank can be screwed back onto the base.

### FILLING THE TANK



First, turn the top cap until the markings align and the top cap can be removed.

Now fill the tank with liquid. It holds approximately 3.5 ml of fluid.

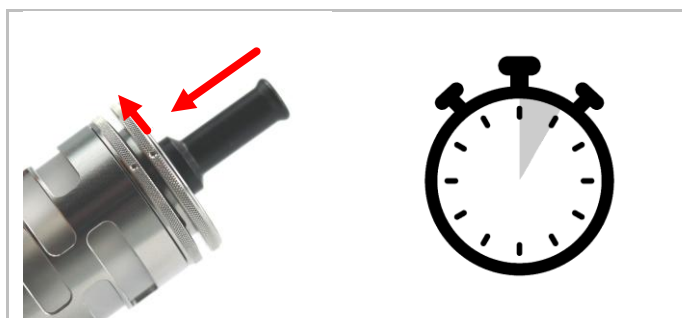

Then place the top cap back on and lock it with a short twist.

Wait for 5 minutes!

#### IMPORTANT

- After filling, wait a few minutes to allow the coil head to become fully saturated with liquid.
- Once the coil head is properly soaked, you can start vaping.
- Refill the liquid in time to prevent the coil head from running dry.
- Do not use the atomizer with the tank open.





## ADJUSTING THE AIRFLOW

The size of the air intake can be adjusted using the AFC ring. To do this, turn the AFC ring on the base either to the left or right. The AFC ring clicks noticeably into six distinct positions. The "closed" position is intended for transport only.



### IMPORTANT

- Make sure the air inlets are clear before using the atomizer.
- Remove any dirt or debris from the air inlets.
- Do not use the atomizer with the airflow closed; this setting is intended for transport only.
- If some moisture appears, it may be condensation. Wipe it off with a clean cloth.
- If larger amounts of liquid leak, please replace the coil head and check the O-rings for proper sealing.



## 8. CLEANING REINIGUNG

- Do not use cleaning agents, as they may damage the sealing rings.
- Before reassembly, check that all sealing rings are present and correctly positioned to prevent liquid leakage.
- Disassemble the atomizer into its individual parts.
- Clean the components (except for the cotton) under running water or in an ultrasonic bath.
- Allow all components to dry completely before reassembling the atomizer.

## 9. MAINTENANCE

Wait until the atomizer has completely cooled down before performing any maintenance work.

Before carrying out maintenance, ensure that there is no power supply by either unscrewing the atomizer from the battery mod or switching off the battery mod.

### REPLACING THE TANK

If the tank is damaged or broken, it must be replaced.

- Use only original spare parts, which can be obtained directly from [www.smokerstore.de](http://www.smokerstore.de) or through authorized SmokerStore retailers.
- Before replacing the tank, make sure the atomizer is completely emptied.
- As an alternative to the two-piece tank consisting of a tank insert and tank sleeve, the optional full tank can also be used.

### REPLACING THE SEALING RINGS

Sealing rings are used to ensure the atomizer is properly sealed.

- If you notice liquid or moisture leaking from the atomizer, brittle sealing rings that need to be replaced may be the cause.
- Moistening the sealing rings with liquid makes it easier to assemble the atomizer.

## 10. ASSEMBLING THE ATOMIZER

- The atomizer is usually delivered fully assembled; the following instructions are intended, for example, to assist with reassembly after cleaning.
- Moistening the sealing rings with liquid makes assembly easier.

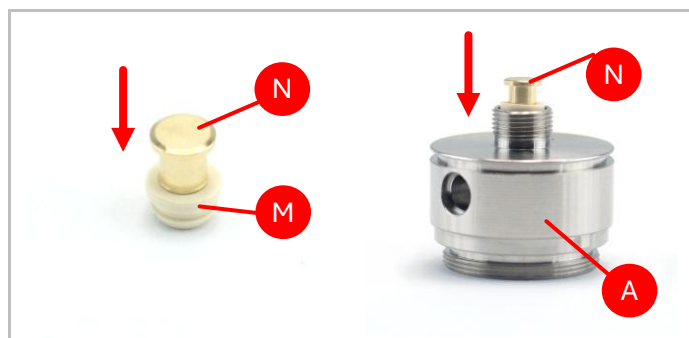

Insert the positive pin [N] into the positive insulator [M].  
Then press both into the base [A] from the underside.

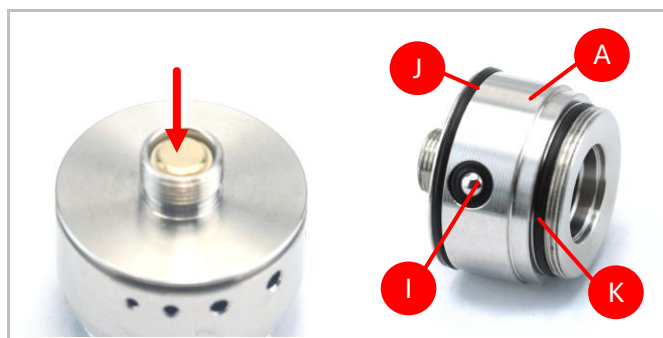

Press the positive pin [N] fully into the connector.  
Now attach the O-rings [J, K] and the ball detent [I] to the base.

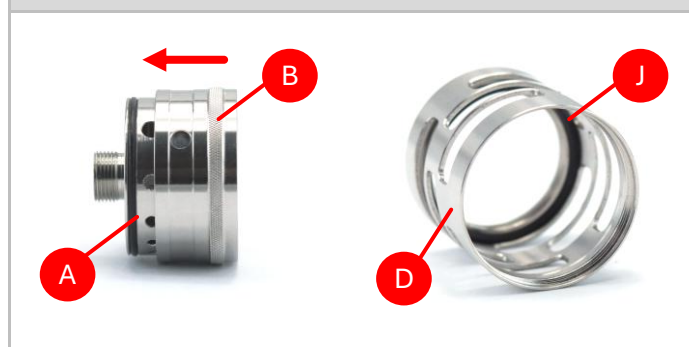

Slide the AFC ring [B] over the base [A].  
Then install the O-ring [J] into the tank sleeve [D].

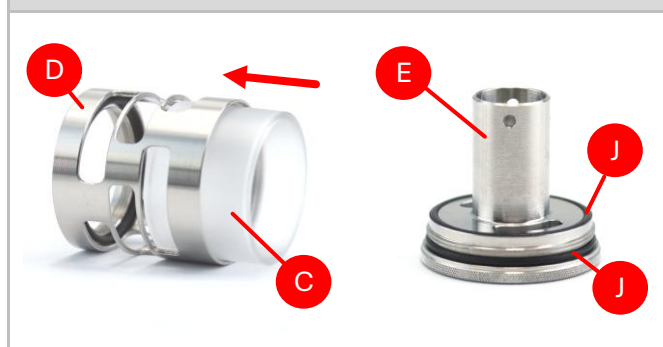

Insert the tank insert [C] into the tank sleeve [D].  
Now the O-rings [J] can be attached to the chimney [E].

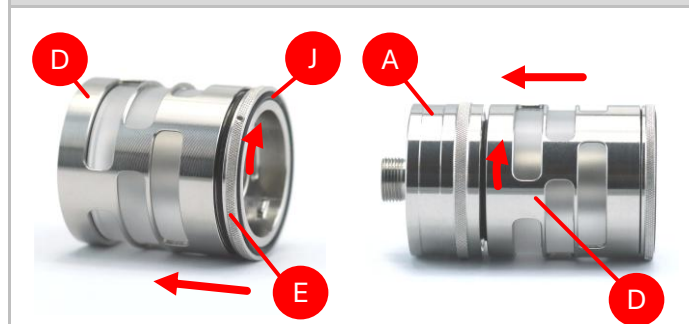

Place the O-ring [J] on top of the chimney [E]. Then screw the chimney [E] to the tank sleeve [D] and attach the assembly to the base [A].

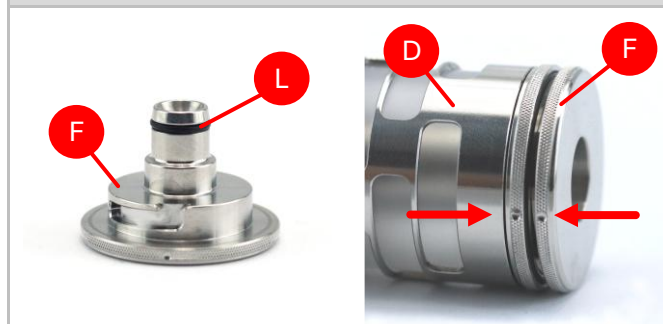

Attach the O-ring [L] to the top cap [F]. Then place the top cap [F] onto the chimney [E].  
Please make sure the two alignment markings are properly positioned.

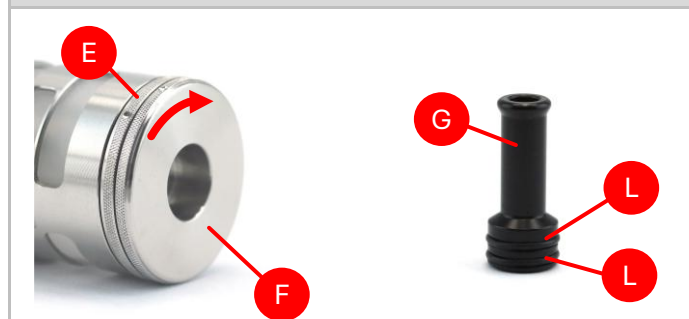

With a slight twist, the top cap [F] is now secured to the chimney [E].  
Next, attach the two O-rings [2x L] to the drip tip [G].



Insert the drip tip [G] into the top cap [F].  
Done!